

**EXLABESA**  
INDUSTRY

Massive. Beautiful.  
Efficient.

Impossible?  
Not for us



# Extruding and shaping your world

At **Exlabesa** we want to make aluminium a solution that allows the world to have the shape it needs, discovering new ways for industry.

We make true the needs, dreams and aspirations of those who surround us, inspiring new possibilities, extruding and giving impossible shapes to aluminium, with the capacity of a giant and the precision of those who take care of the details, to help you get where nobody has arrived before.

We design, research, extrude and manufacture the perfect solution to help you in making everything you can imagine possible, with the conviction and certainty of making it happen, thanks to our experience, inimitable production capabilities, state-of-the-art technology and the best talent in the industry ready to make possible the impossible.

30

EXTRUSION  
PRESSES

12

PAINTING  
PLANTS

12

POLYAMIDE  
ASSEMBLY LINES

34

MACHINING  
CENTRES

5

ANODISING  
PLANTS

3

BENDING  
CENTRES

4

RECYCLING  
PLANTS



Massive. Beautiful.  
Efficient.

You inspire the energy  
that moves us,  
we shape the world  
that inspires you

# Impossible? Not for us

We are Exlabesa, a global leader in production and finishing of aluminium profiles. We offer customized and sustainable solutions for a wide range of market segments such as construction, architecture, automotive, transportation, engineering and renewable energies.

In our more than 50-year company history, we have continuously invested in state-of-the-art technologies. We have all relevant production processes in-house, such as extrusion, surface treatment, mechanical processing, bending and remelting.

1966	Exlabesa Spain Valga
1992	Exlabesa Spain Picaraña & Rois
2001	Exlabesa UK Doncaster
2007	Exlabesa Morocco Tanger
2008	Exlabesa Poland Tułowice
2011	Exlabesa USA Tifton
2016	Exlabesa Weseralu Germany Minden
2022	Exlabesa Portugal Coimbra
2023	Exlabesa Flandria France Warneton



**245 000** m<sup>2</sup>  
OF FACTORY

**238 000** Tm/year  
EXTRUSION CAPACITY

**174 000** Tm/year  
EXTRUDED ALUMINIUM

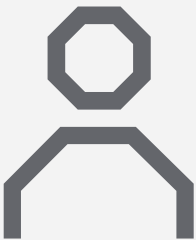

**16 000**  
CUSTOMERS

**2000**  
EMPLOYEES

**22**  
WORK CENTRES



**51**  
COUNTRIES

**10**  
PRODUCTION CENTRES

**3**  
CONTINENTS

3500  
TONS PRESS

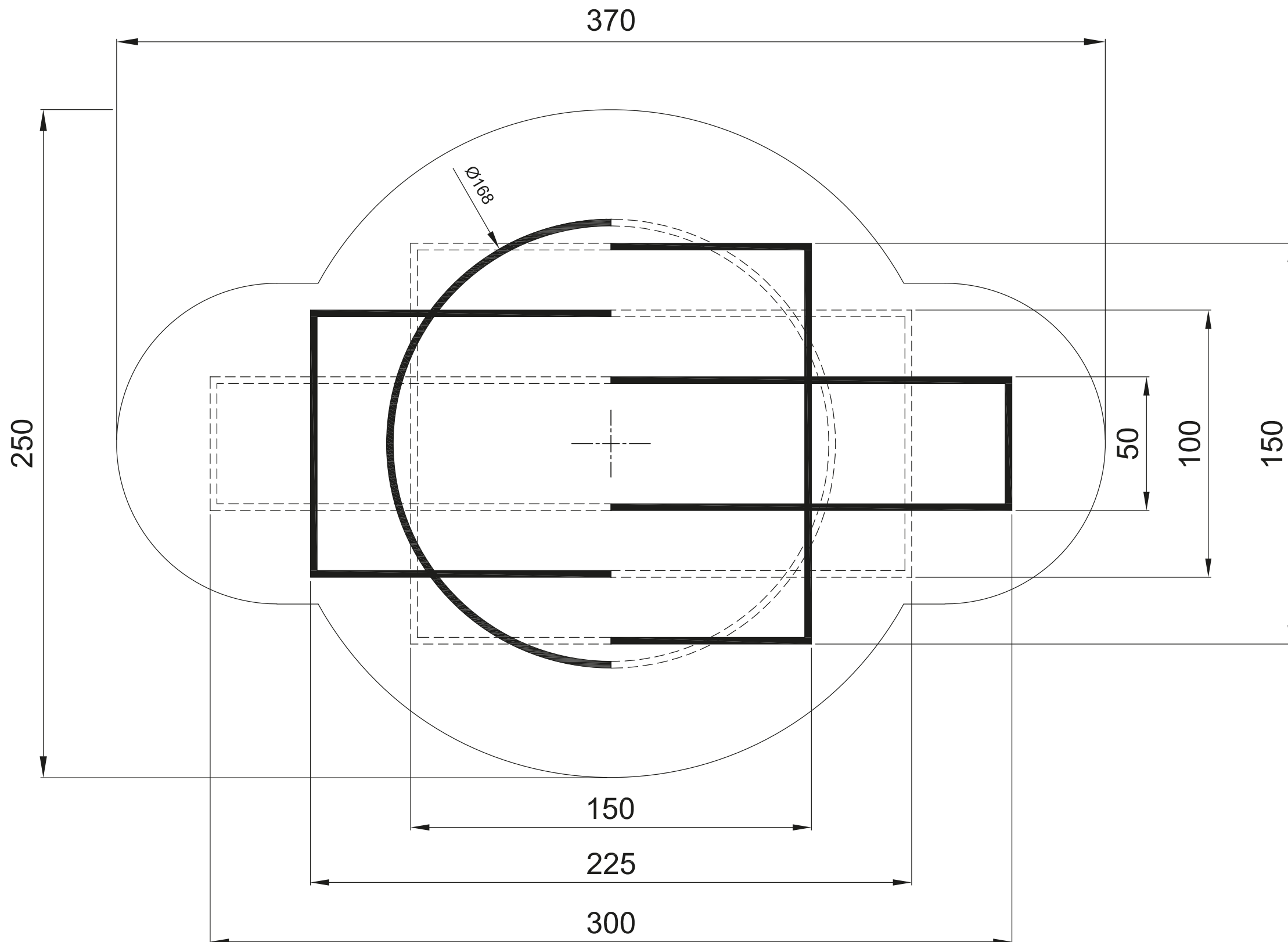

# Capabilities born from your needs

At our 8-acre site in Doncaster we have invested in the latest machinery to ensure that we offer our customers the very best quality on extrusions, polyester powder coating, anodising, thermal break, CNC and precision recut.

## EXTRUSION

Extrusion presses	16 & 35 MN
Maximum length	14 000 mm
Minimum / Maximum weight	0,1 - 11 kg/m
Alloys	1070, 6005, 6060, 6061, 6063, 6082, 6101

## CNC MACHINING & PRECISION RECUT

Maximum length	7000 mm
Useful length	6770 mm
Useful width	540 mm
Useful height	300 mm
Course C axis	-90° 0 +90°
Positional accuracy	±0,1 mm
Operations	Drilling, milling, rectangular slots, tumble debur, precision cut, counter sinks, tapping
Precision cutting saws	Tolerance of ±0,2 mm / 1° inclination

## PAINTING (Polyester Powder Coating)

Maximum length	7500 mm
Finishes	All RAL colours, Polish, Matte, Textured, Satin
Certification	Qualicoat

## ANODISING

Maximum length	6400 mm
Up to	25 micron thickness



## **Exlabesa Extrusions Doncaster Ltd.**

Ogden Road - Wheatley Hills  
DONCASTER DN2 4SG  
Tel. +44 01302 762500 Fax +44 01302 762557  
[www.exlabesa.com](http://www.exlabesa.com)

QUALICOAT | ISO 9001 | PAS 24:2016

