

KC75
Premium
window system



Flush design. Premium performances.

The KC75 is a premium aluminium window system ideal for both new construction and renovation endeavors. It stands out as the optimal choice for demanding projects such as schools, hospitals, or public buildings that require robust, long-lasting and easy to fabricate products.

Available in top-hung and side-hung applications, the system features an injected polyurethane foam and a polyamide thermal break in the profiles to improve thermal efficiency. Furthermore, the product can be dry-glazed internally or externally using clip-in beads.

KC75 casement is fully compliant with current Building regulations and it has been PAS-24 approved guaranteeing extra security to any project.

Flush design

The KC75 has been upgraded with a bold new look. The product is now available in two different design options: with a stylish and contemporary casement aesthetic, or a flush sash option.

Fabricator friendly and cost-effective solution

Thanks to its fabricator friendly design, KC75 can be quickly and easily fabricated to tight deadlines. It is fully compatible with Exlabesa systems and accessories range allowing to use standard Exlabesa corner cleats, gaskets, beads, cills, corner posts or add-ons.



Massive. Beautiful.
Efficient.

Features

- U-value as low as 1,2 W/m²K
- Top & side hung applications
- Internally or externally beaded
- Mechanical corner joints for easy fabrication
- Cills, couplers, add-ons and curtain walling inserts available
- High Insulated version using polyurethane foam

✓ PAS 24 Security

✓ BS6375-2

✓ PART L





Option
FLUSH DESIGN



Option
STANDARD DESIGN



STANDARDS COMPLIANCE

Made in Britain to meet performance and security requirements of current Building Regulations.

PART L: U-Value as low as 1,2 W/m²K (triple glaze unit).
PAS 24 security certified.



DESIGN

Available in two different design options: with a stylish and contemporary casement aesthetic, or a flush sash option designed to mimic the timeless look of a timber window. It's slimline aluminium frames maximizes the glass area and allows for uninterrupted views.

FEATURES

With a glazing range from 24 to 56 mm the system can easily adapt to double, triple glazed units or even units incorporating interstitial blinds. Also, the high insulated version introduces injected polyurethane foam to further improve thermal efficiency for higher specification projects.



POSSIBILITIES

Available in both top-hung and side-hung applications, this system, featuring internal or external beading, also provides choices for open-out and French openings.

BENEFITS

Specially developed for demanding projects where durability, robustness and reliability are essential criteria. It can be quickly and easily fabricated thanks to its effective corner cleat solution. Its complete range of 75 mm subframe and coupling sections make this window appropriate for ribbon runs or school refurbishment and commercial buildings.

Massive. Beautiful.
Efficient.

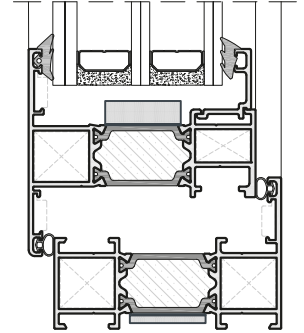
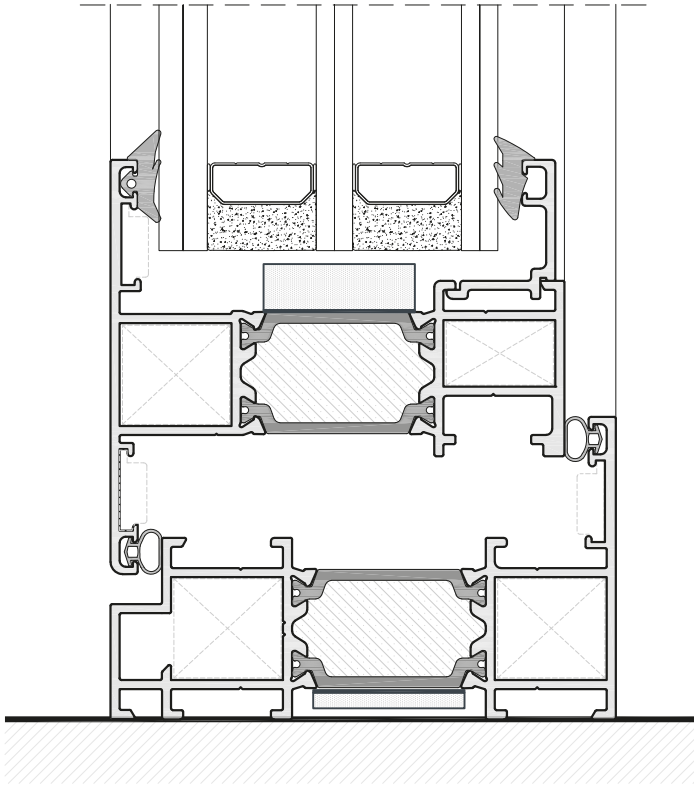

Maximum sash size

1500x1500 mm top hung
900x1500 mm side hung

Maximum weight

50 kg

Maximum glazing

56 mm

U_w value

1,2 W/m²K (triple glaze unit)
1,4 W/m²K (double glaze unit)

✓ PAS 24 Security ✓ BS6375-2

Air permeability

Class 3

Watertightness

9A

Wind load

C5

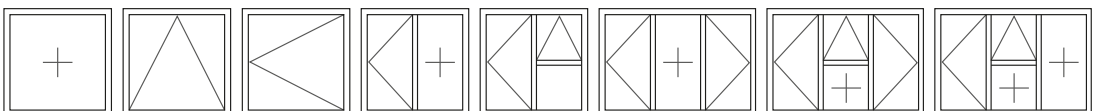



Exlabesa Building Systems Ltd.

Ogden Road - Wheatley Hills
DONCASTER DN2 4SG
Tel. +44 01302 762500 Fax +44 01302 762557
www.exlabesa.co.uk

QUALICOAT | ISO 9001 | PAS 24:2016

